

SCHEMATIC NOTES:

- LAYOUT SHOWN FOR PLANNING PURPOSES ONLY, NOT FOR CONSTRUCTION.
- ALL FURNITURE, EQUIPMENT AND APPLIANCES (REFRIGERATORS, COPIERS, FILE CABINETS, ETC.) SHOWN ARE FOR PLANNING PURPOSES ONLY AND ARE PROVIDED AND INSTALLED BY TENANT.
- ALL MILLWORK SHOWN MAY BE ABOVE BUILDING STANDARD AND IS TO BE DETERMINED BY BUILDING OWNER.
- ALL FURNITURE SHOWN IS FOR PLANNING PURPOSES ONLY AND DOES NOT REFLECT ACTUAL SIZES OF TENANT'S FURNITURE.
- ALL GLASS SHOWN MAY BE ABOVE BUILDING STANDARD AND IS TO BE DETERMINED BY BUILDING OWNER.
- ALL WALLS WITH GLASS TO BE BRACED TO DECK ABOVE.
- ALL EXISTING DOORS AND HARDWARE TO BE FIELD VERIFIED TO DETERMINE IF THEY CAN REMAIN AND/OR BE RELOCATED.

LEGEND:

- EXISTING PARTITION TO REMAIN
- EXISTING TENANT SEPARATION PARTITION
- NEW SLAB TO SLAB PARTITION WITH INSULATION
- NEW SLAB TO CEILING PARTITION
- OPEN TO DECK ABOVE. ALL OTHER AREAS TO BE BUILDING STANDARD GRID AND CEILING TILE, UNLESS OTHERWISE NOTED
- N NEW FRAMELESS FULL GLASS DOUBLE ENTRY DOOR
- N1 NEW BUILDING STANDARD DOOR

SUITE 303S

CITY CENTER
100 SECOND AVENUE SOUTH
FLOOR 3
ST. PETERSBURG, FL 33701

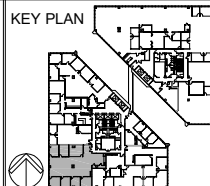

SPACE PLAN - REVISION 2

RENTABLE AREA: 3,637 SF
REV 2 DATE: 03/11/22
DATE: 01/27/22
SCALE: NTS
PROJECT #: 1534
DRAWN BY: JES

CMK Design Studio, Inc.
Planning & Design of the Built Environment

6822 22nd Ave. N. #148
St. Petersburg, Florida 33710
Ph: 727.515.8461

LIC NO: AA26002603